

Town of Berry Fire District Boundaries

March 2005

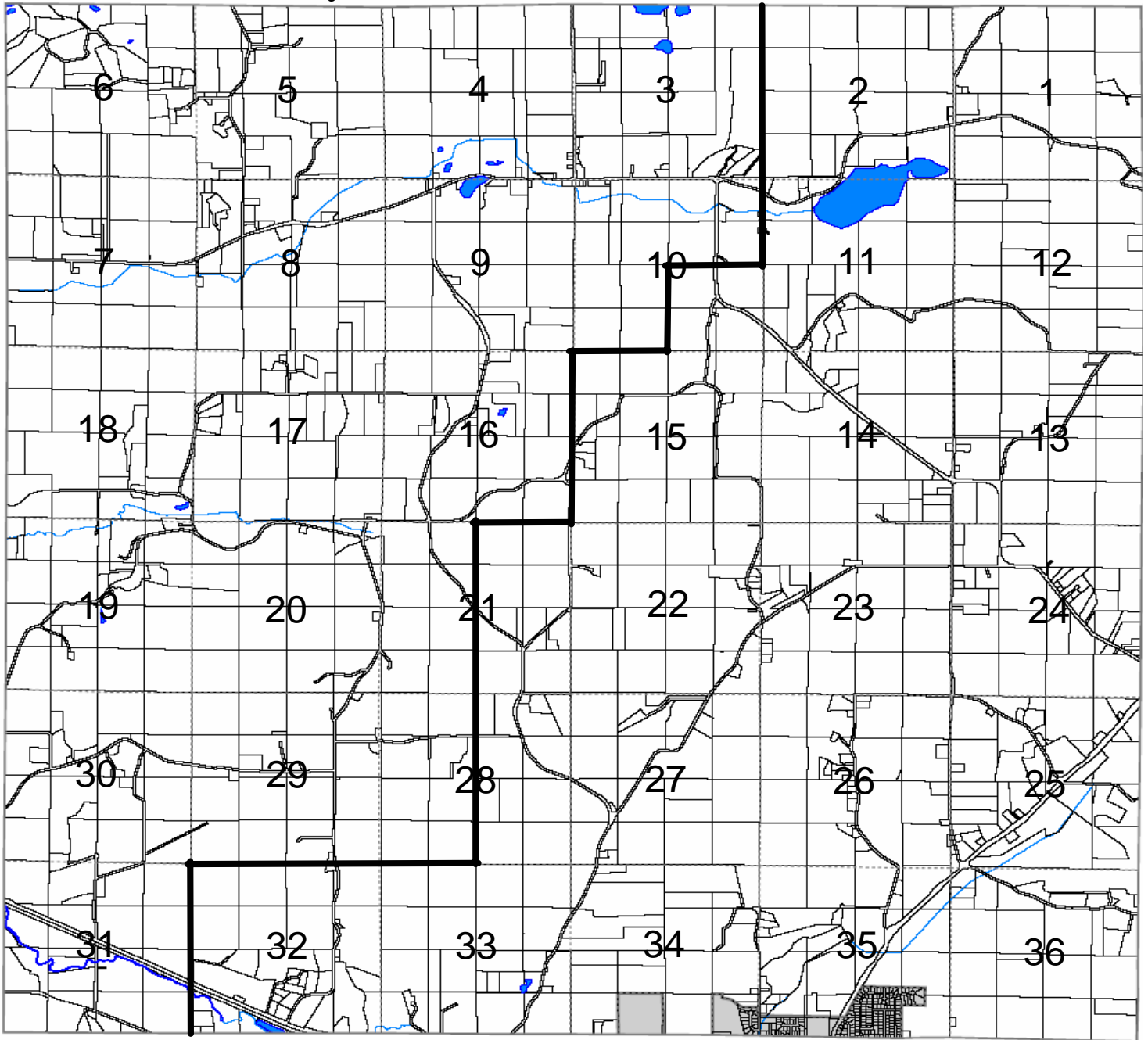

Black Earth Fire District: Sections 3, 4, 5, 6, 7, 8, 9, all of Section 10 except the SE 1/4 , Sections 16, 17, 18, 19, 20, the W 1/2 of Section 21, the W 1/2 of Section 28, Sections 29, 30, and 31.

Cross Plains Fire District: Sections 1, 2, SE 1/4 of Section 10, Sections 11, 12, 13, 14, 15, E 1/2 of Section 21, Sections 22, 23, 24, 25, 26, 27, E 1/2 of Section 28, Sections 32, 33, 34, 35, and 36.